

Hello



BIBO
Classic
User's manual



Congratulations on your BIBO purchase!

Congratulations and thank you for buying a BIBO Classic. You are moments away from enjoying pure, filtered water – boiling and chilled – at the touch of a button.

We want you to get the most from your BIBO, so before you use it please read this manual carefully.

If you have any queries once your BIBO is up and running, please first refer to this manual, it will provide you with helpful and practical advice. There are also a number of videos on our website to guide you through using the BIBO Classic.
www.bibowater.co.uk

Please feel free to contact us if you have any further queries or to give any feedback on your BIBO or our service. Whatever you need, our support team is just an email or a phone call away

Visit www.bibowater.co.uk/contact, email customers@bibowater.co.uk or call **0800 678 5969**

Please note

The pictures and diagrams in this manual are for reference only, please refer to your BIBO.

We reserve the right to make corrections or changes to the information provided in this manual without prior notice being given.

The products, functions, structures and designs described in this manual have been patented by our company and are thus protected by the UK & EU patent offices.

Version number 010819

© Copyright BIBO 2019. All Rights Reserved

Contents

Meet your BIBO page 4

- BIBO overview
- The touch screen

Using your BIBO page 6

- Important: before using your BIBO for the first time
- Main features
- Menu options & personal settings

BIBO information & maintenance page 14

- How to replace the filters
- How to clean your BIBO
- How to clean the hot tank
- Technical information
- Safety notes

Appendices page 20

- Self-installation instructions
- Resetting the thermal overload switch
- Changing the panels
- Going on holiday
- Moving house

Meet your BIBO

BIBO overview

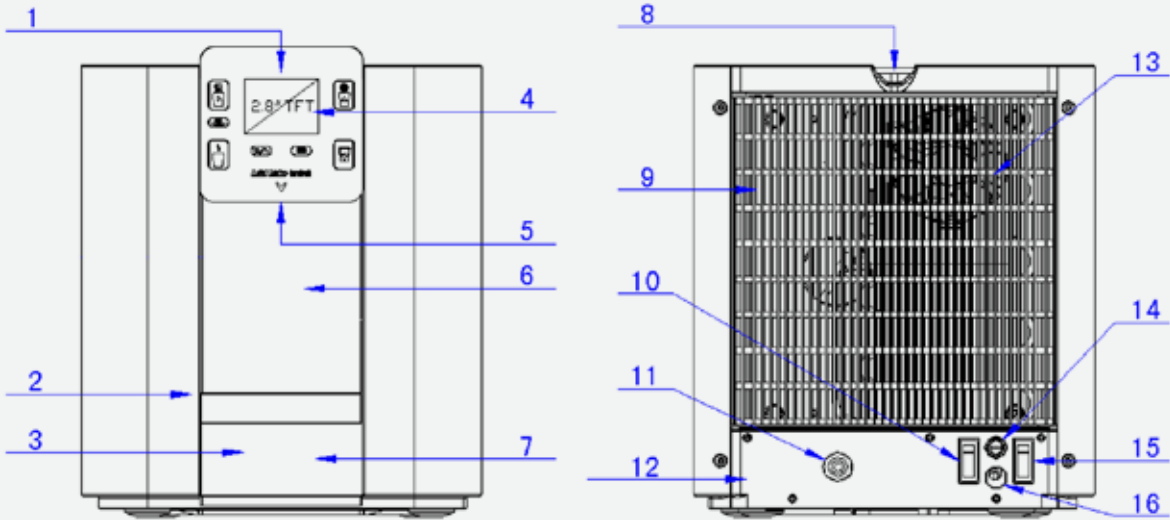

1. Touch screen

2. Drip tray cover

3. Removable drip tray

4. LCD screen

5. Dispense nozzles

6. Front panel

7. Overflow reservoir

8. Lid
9. Refrigeration condenser

10. Hot tank switch

11. Water inlet

12. Rear panel

13. Cooling fan









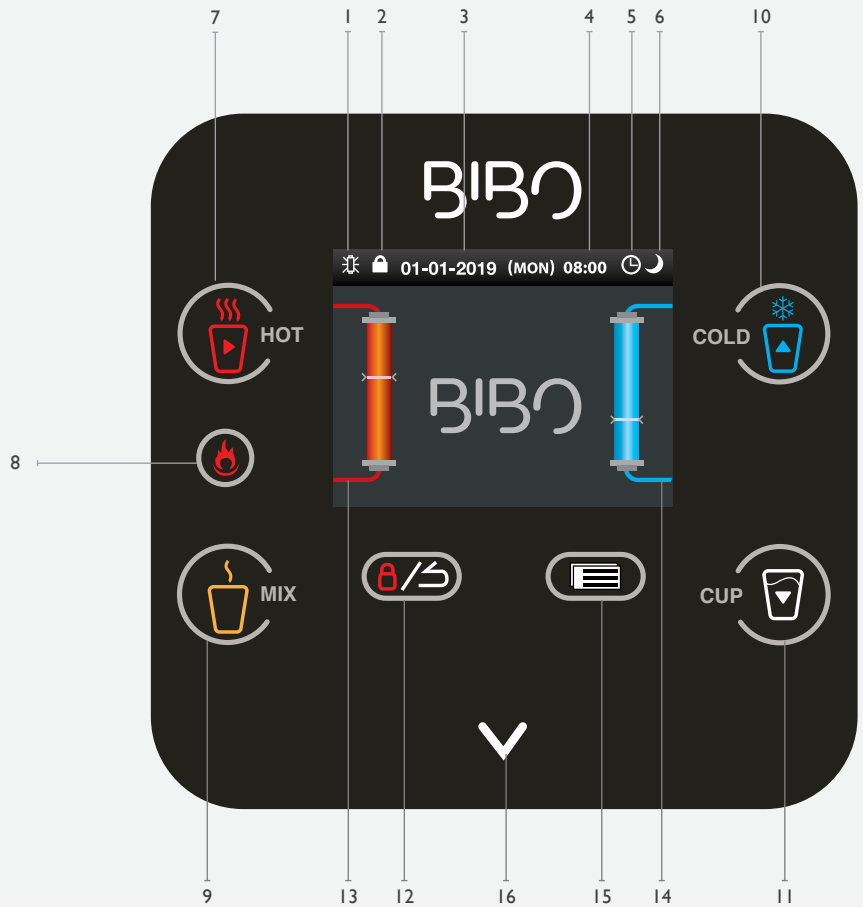



14. Mains fuse

15. Power switch

16. Mains power cable

The touch screen

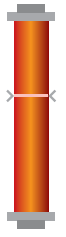
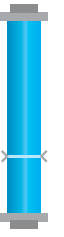

1  UV filter status icon	2  Child lock status icon	3 01-01-2019 Calendar (Day - Month - Year)	4 08:00 Clock (24 hour)	5  Automatic on/off icon	6  Power saving mode icon
7  Hot water key (also acts as "navigation" key in menu mode)	8  Extra hot water key	9  Ambient (mixed hot & cold) water key	10  Cold water key (also acts as "adjust" key in menu mode)	11  A cup of water key (also acts as "adjust" key in menu mode)	12  Unlock (also acts as "return" key in menu mode)
13  Heating & hot water temperature bar		14  Chilling & cold water temperature bar		15  Menu & save key	16  Water outlet indicator light (red for hot, blue for cold)

Using your BIBO

Initial connection to an electrical supply

Once your BIBO has been plugged in to a power supply, the screen will initially display the BIBO logo. Follow the instructions on the screen, adding hot and cold water to the respective tanks. (Once the tanks are full, water will flow from the dispense nozzles at the front of the dispenser.)

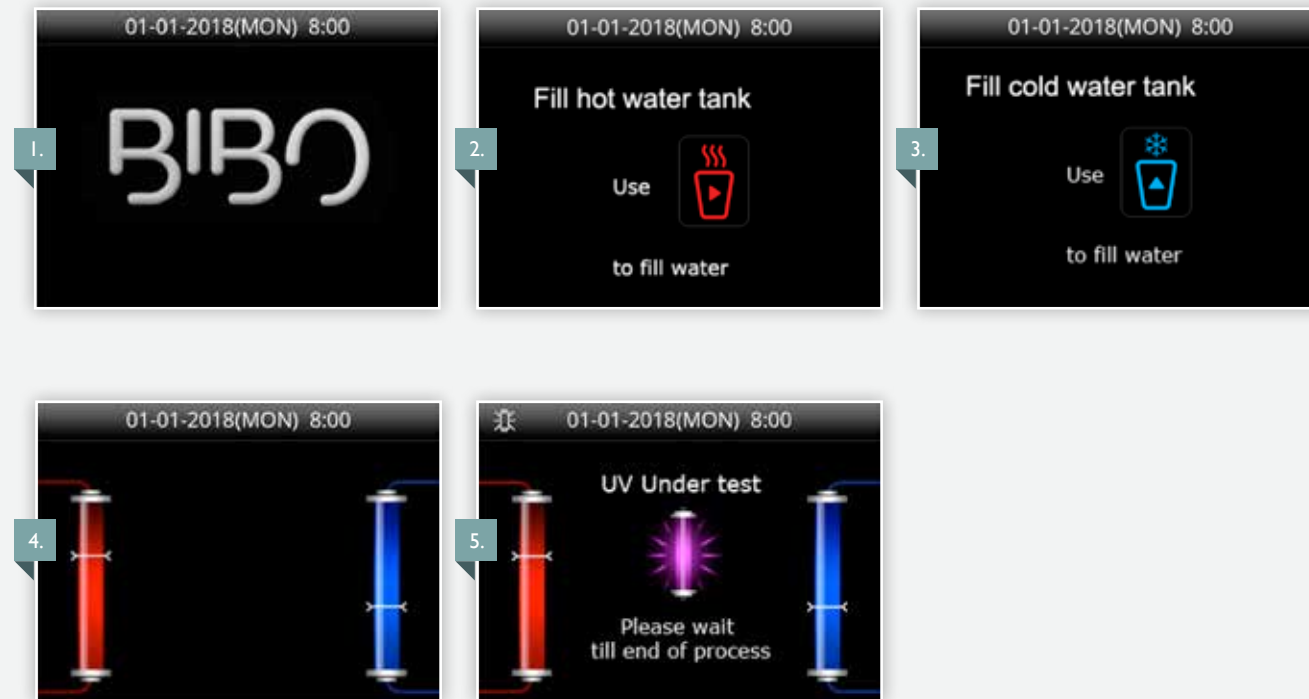

After turning your BIBO on for the first time we suggest you dispense at least 2 litres of water using both the hot & cold keys.

Before using your BIBO for the first time

Important: When using a new or freshly cleaned BIBO for the first time, it's important that water is flowing from both the hot and cold dispense nozzles when the keys are touched, before you switch on the hot water tank. If you are self-installing your BIBO, please see the appendix "Self-installation instructions" at the back of this manual.

Once you have flushed 2 litres of water through the system, turn the hot tank on using the switch at back of the machine (see page 4 of this guide for its location). A prompt will appear to check the hot tank is full of water. The hot tank will then begin to heat up and the hot water temperature bar will be active on the screen. When first used, the hot tank will take approximately 5 minutes to get up to maximum temperature. The cold tank takes approximately 15 minutes to get to minimum temperature.

Performance tip: Depending on your local water pressure it may be necessary to reduce the flow of water into your BIBO to control the rate at which the water is dispensed particularly from the hot tank. If the flow from the hot tap is too fast this may reduce the number of consecutive cups of very hot water available in one go. The flow can be adjusted by partly closing the tap on the connector used to connect to your water supply.

Maintenance tip: To keep your hot tank working efficiently it's important that the build-up of mineral deposits in the tank is regularly removed. It's a simple process and we provide a DIY kit for this purpose. We recommend you clean your BIBO every 6 months to avoid symptoms of lime scale occurring.

Main features

To dispense hot water:

The BIBO has a safety lock so you must first touch then touch Hot water will flow until you touch any key to stop the water.



If you require near-boiling water touch the dispenser will display the following:



Once boiling has finished you can dispense water from the BIBO.

To dispense cold water

Touch then cold water will flow until you touch any key to stop the water.



To dispense ambient (mixed) water

Touch then ambient water (a mixture of hot & cold water) will flow at the temperature and volume you have set. You can, however, touch any key to stop the water.



To dispense a measured cup of hot or cold water

Touch then touch either or for a measured cup of hot or cold water. To set the quantity of how much water the will dispense, please see page 9 in this manual.

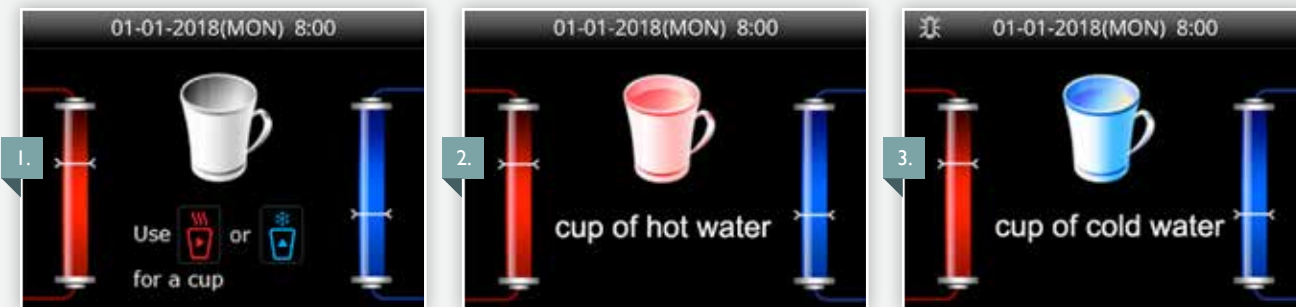

Menu options & personal settings

The menu allows you to control temperature settings, water quantity settings, time and date settings, energy saving mode, child lock settings, filters and UV lamp change settings, language settings, ring tone settings and there's also an option to restore BIBO's factory settings.

To enter the menu

Touch on the panel, then follow the on-screen prompts.

Touch to scroll through the menu options until the one you wish to change is in the centre of the screen highlighted in brown. Then touch to select that option. Touching at any time will take you back to the previous screen. Touch and/or to adjust the option settings. Touch to save your settings.

Water temperature settings

Select the temperature (Temp) setting in the menu then follow the screen prompts to set the hot, cold & ambient (mix) water temperatures as shown below. Touch the to save the changes. An 'OK' message will appear on the screen.

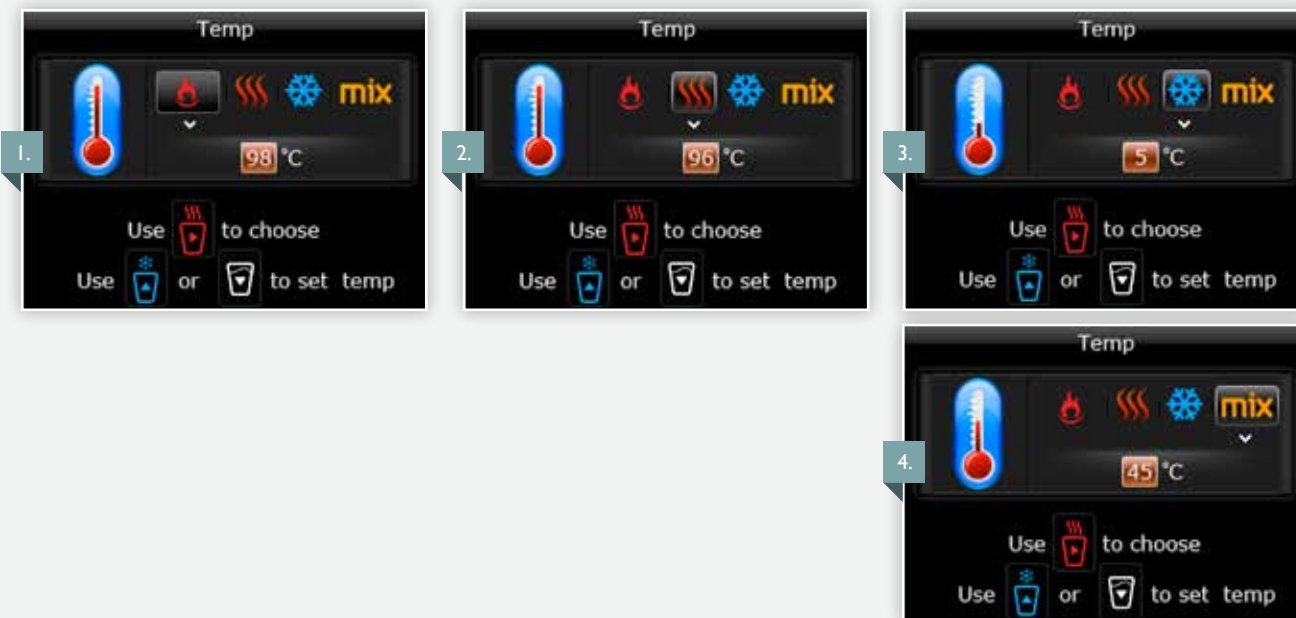

Water quantity settings

Select the water quantity (QTY) setting in the menu then follow the screen prompts to set the hot, cold & ambient (mix) water quantities as shown below. Touch the to save the changes.



Time setting (year - month - day)

Select Calendar settings and enter the time adjustment screen. Follow the prompts to set the date, time and your preferred time format, as follows:

Touch to save your selections

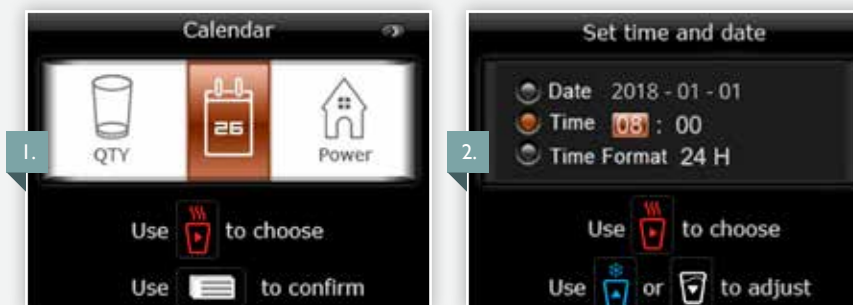

Energy-saving mode

The BIBO has two energy-saving features, a sleep mode and a power off mode.

Sleep Mode

Sleep mode allows you to set your BIBO to go into a low power state if you don't use it for between 1 and 4 hours. When sleeping the cold water temperature is unaffected and stays chilled; the hot water temperature slowly drops to 60°C.

When the BIBO goes into sleep mode it will display the message shown on screen No.4 overleaf. Simply press any key to wake it up again. The hot tank will take a few minutes to reach maximum temperature.

To activate sleep mode select the "Power" option in the menu. Touch the key to select "Sleeping", touch the key to select ON. Touch the key then touch the key to adjust the elapsed time before the BIBO goes to sleep. Touch the to save the changes. When this option is selected a will appear in the top right corner of the home screen.

Touch the 3 times or wait 30 seconds to return to the home screen.

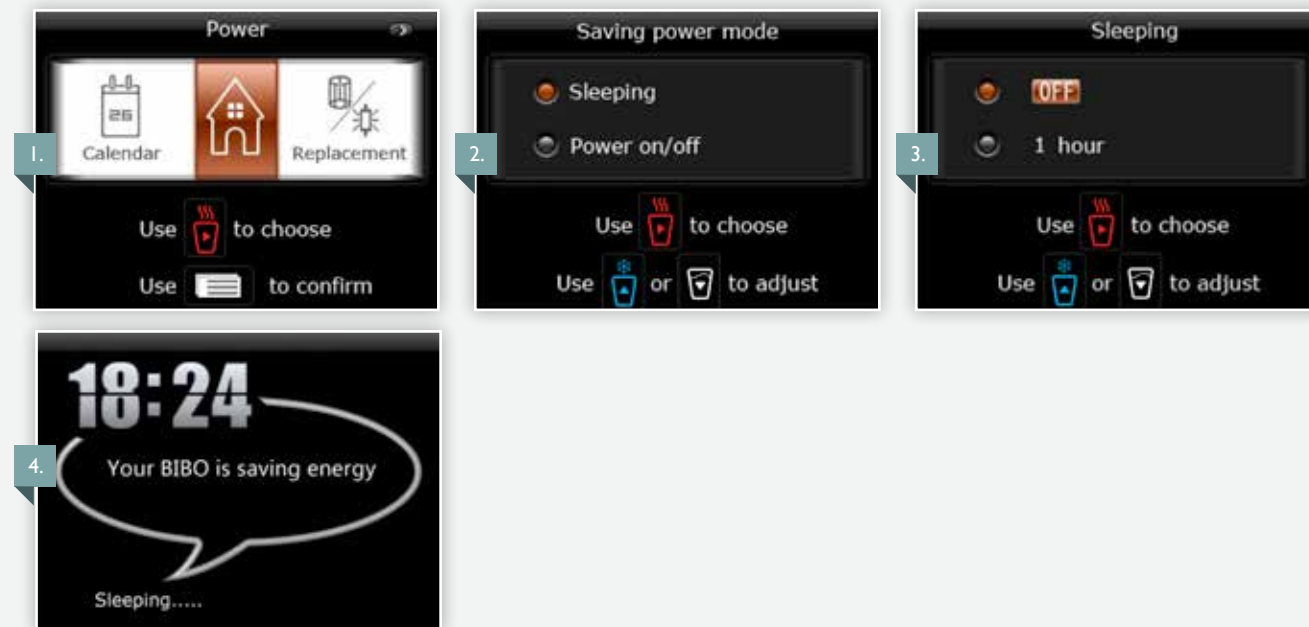

Power on/off mode

Power on/off mode allows you to set your BIBO to come on and go off at different times of day – exactly like your central heating. There are three timed ‘periods’ available when the BIBO can switch itself on then off again. Select the Power option in the menu; touch the key to scroll down to the Power on/off option. Touch the key to select, touch the key to turn on the first time period then use the key to scroll across to the hour setting for when you wish your BIBO to turn itself ON, use the or key to adjust up or down, then scroll across to the minute setting and adjust in the same manner. Scroll across to the OFF time setting and adjust accordingly. Touch the key so save your changes. Using the key you can scroll down to the second and third time ‘periods’ if you wish to use them. These can be adjusted and saved as above. When this option is selected a will appear in the top right corner of the home screen.

Touch the 3 times or wait 30 seconds to return to the home screen.



When the BIBO goes into power on/off mode, it will display the following screen in the display:



If you want to turn your BIBO on before the programmed time, touch any key and the screen will display this:



Touch the key to confirm you want it to turn on. When BIBO switches back on again from the power on/off mode, the hot tank will take approximately 5 minutes to heat back up to the maximum temperature and the cold tank will take approximately 15 minutes to chill back down to the minimum temperature.

Child lock setting

To set the extra child lock, select the “Child lock” option from the menu. Follow the prompts to turn the child lock on or off:

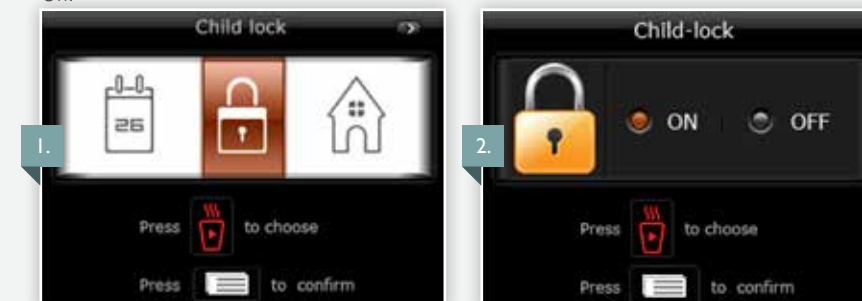

Once the child lock has been set, it will only be possible to dispense hot water by touching the key for more than 3 seconds after you have touched the .

MAXI filter & UV filter maintenance settings

To see how long is left until your filters need changing, select “UV / filter replacement” from the main menu. For the MAXI filter; select “Filter” and the screen will tell you how long is left until you need to change it for a new one.



Repeat for the UV filter; choosing “UV” instead of “Filter” from the menu.



Ring/beep setting

You can programme your BIBO to beep every time a key is pressed by choosing “Ring” from the main menu, and selecting whether you want it on or off.

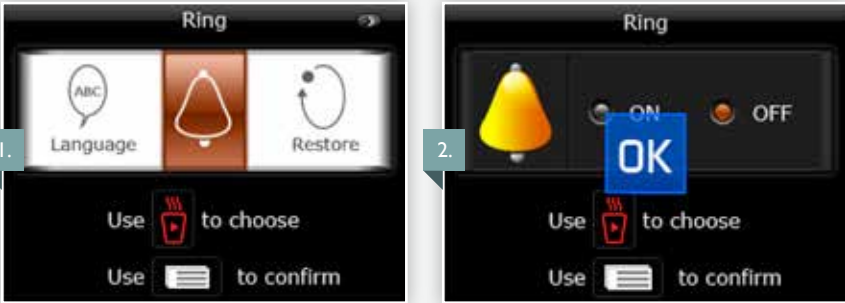

Restore factory settings

To restore all settings to factory settings, choose “Restore” from the main menu and then choose “ON”.

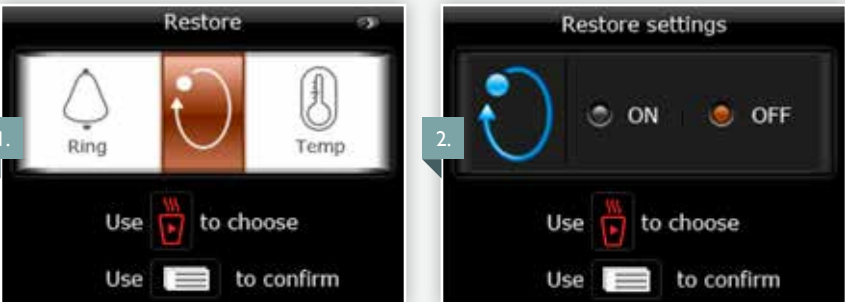

BIBO information & maintenance

Replacing the MAXI filter cartridge

BIBO's MAXI filter cartridge should be replaced every 6 months. When the filter needs replacing, the BIBO's display will alert you. This message will appear once replacement is due:



Remove the lid on the top of BIBO by simply lifting it off. It is best to lift the lid from the back first.



You will see the white top of the MAXI filter cartridge towards the back of your BIBO with a handle protruding from it. Turn the handle firmly anti-clockwise until the filter cartridge releases, then pull it up and out of the BIBO.

In the event that the cartridge is too stiff to turn please use the filter spanner supplied with your filter pack. It may also help to relieve the water pressure in the BIBO. To do this turn off the water supply to the BIBO, then touch the key to dispense a small amount of cold water. The cartridge will now be easier to remove. Remember to turn the water supply back on once the new MAXI cartridge has been fitted.

OPEN - Rotate firmly anti-clockwise to remove the used filter:

CLOSE - Rotate firmly clockwise to install the new filter:

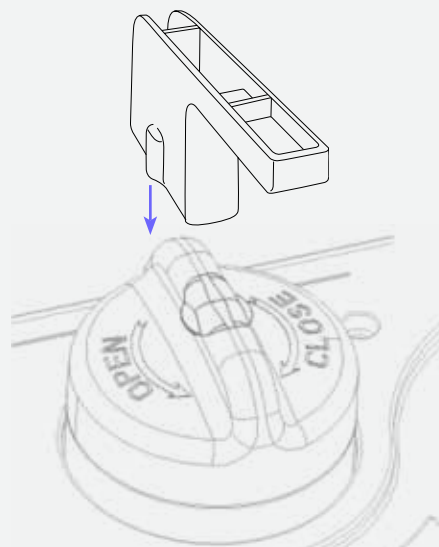

Remove the new MAXI filter cartridge from its packaging and insert it. Then, using the filter spanner provided, turn it firmly clockwise to install.

Once the MAXI filter has been replaced you have to instruct the BIBO that there's a new cartridge fitted. Touch the key once, then touch the key five times to select "UV/Filter replacement", now touch the key three times to reset the counter to "180 days left". After 30 seconds the screen will revert to the home screen.

Replacing the UV filter lamp



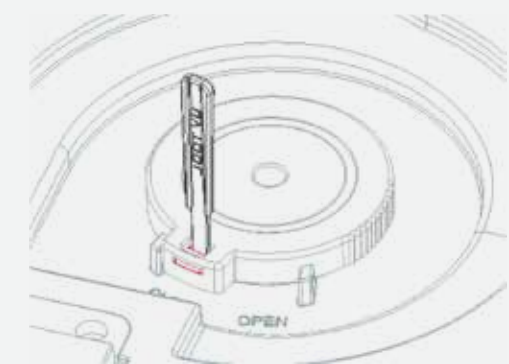

The UV filter lamp should be replaced every 12 months. When it needs replacing, BIBO's display will alert you. This message will appear once replacement is due:

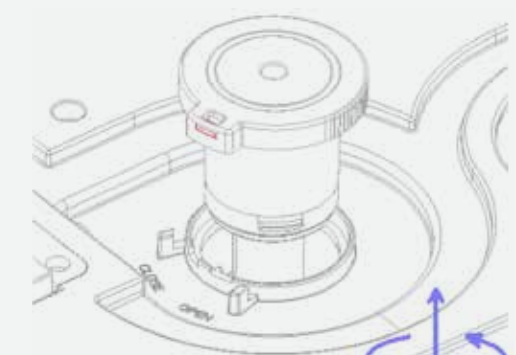
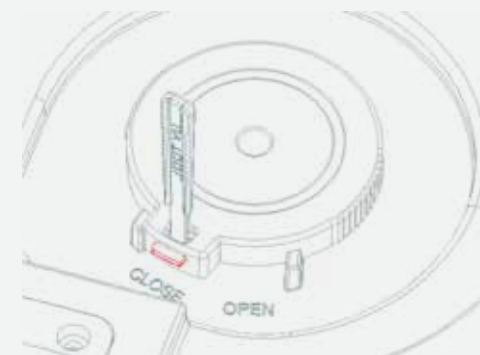

You will see the white cap of the UV filter lamp towards the front of your BIBO. Locate the small, white plastic key supplied with your new UV lamp. Put the key in the slot as indicated below, release the latch by levering the red tab forwards and rotate the UV lamp anti-clockwise to the "OPEN" position. Pull the UV lamp up and out of the BIBO.



Remove the replacement UV lamp from its packaging and insert it carefully. Then rotate it clockwise to the "CLOSE" position, it will click and lock.

Once the UV lamp has been replaced you have to instruct the BIBO that there's a new lamp fitted. Touch the  key once, then touch the  key five times to select "UV/Filter replacement", now touch the  key once then the  key once then the  key twice to re-set the counter to "360 days left". After 30 seconds the screen will revert to the home screen

If you need more help or information on changing your filters, there's a video demonstrating how to replace them both on our website at www.bibowater.co.uk/help/

Cleaning your BIBO

Clean your BIBO by simply wiping it down with a damp cloth. Soap or any other gentle detergent can also be used if you wish. The drip tray can be removed and cleaned in a dishwasher.

Please don't use harsh detergents, concentrated washing up liquid or solvents to clean your BIBO. Avoid using anything abrasive (such as steel brushes, scourers etc) to clean the body as it will scratch.

It's very important that you don't wet the back of the machine whilst cleaning – remember it is connected to an electrical supply.

Cleaning your BIBO hot tank

To control the build-up of mineral deposits in your BIBO hot tank it will need to be cleaned occasionally. It's a simple process & we provide a DIY kit for this purpose.

BIBO Classic - hot tank cleaning guide

Safety tips & guidance:

- The BIBO hot tank cleaning solution is sulphamidic acid, non-toxic & biodegradable. It's designed to clean the inside of the hot tank & remove any mineral deposits.
- It's important that you read the safety guidance label on the bottle, & that you wear gloves when handling the cleaning solution.
- **The cleaning solution will NOT work properly if the temperature of the water in the hot tank is above 70C so it's very important that you let the tank cool before cleaning so dispense 3litres of water once the tank has been switched off.**
- **If there's a substantial build-up of mineral deposits in the hot tank it may require more than one attempt to properly remove it. The longer the cleaning solution is left in the hot tank the better. We suggest leaving it for at least 8 hours. In extreme cases the hot tank may need to be replaced.**
- **CLEANING OR REPLACEMENT OF THE HOT TANK IS NOT COVERED BY YOUR WARRANTY.**
- **YOUR BIBO MUST NOT BE USED UNTIL THE CLEANING SOLUTION HAS BEEN THOROUGHLY RINSED FROM THE HOT TANK & THE MAXI FILTER CARTRIDGE REPLACED.**

Preparation

- Flick the hot tank switch located at the back of the BIBO next to the power switch to OFF ('0').
- With the hot tank switched off, dispense 3litres of water until the temperature of the water from the tap is cool
- Remove the lid from the top of the BIBO by simply lifting it from the rear.
- Twist anti-clockwise & remove the BIBO MAXI filter cartridge. This will be replaced later

- Fit the cleaning system cartridge into the BIBO & firmly twist clockwise to tighten it
- Using the hexagonal key provided, insert it firmly into the small cap on the top of the cartridge then carefully unscrew & remove the cap
- Take the bottle of BIBO hot tank cleaning solution & carefully snip off the tip of the cap, taking care to keep the bottle upright.
- Carefully empty the entire contents of the bottle of cleaning solution into the cleaning cartridge.
- Replace the small cap in the top of the cleaning cartridge & carefully tighten it using the hexagonal key. Make sure the soft 'O' ring seal is in place.
- Place a suitable drain container (at least 1litre) under the hot tap.

Cleaning

- Dispense at least 1litre of water from the hot tap & discard. Dispense a little more hot water & test it using the enclosed test strip. When the strip changes RED, it indicates that the hot tank is full of the cleaning solution.
- Make sure the drain container is under the hot tap.
- **Now leave the cleaning solution in your BIBO for as long as possible, ideally 8 hours while the hot tank is cleaned & any mineral deposits are removed.**

N.B YOUR BIBO MUST NOT BE USED UNTIL THE CLEANING SOLUTION HAS BEEN RINSED FROM THE HOT TANK & THE MAXI FILTER CARTRIDGE REPLACED.

Rinsing & finishing up

- Dispense at least 3 litres of hot water & discard. Dispense a little more water & test using the test strip; the colour of the test strip should remain BLUE. If still red, dispense more water until the strip remains blue.
- Twist anti-clockwise & remove the cleaning system cartridge.
- To drain the water from the cleaning cartridge, remove the small cap in the top, invert the cartridge over a sink & using the UV lamp removal key press in one of the two valves in the bottom of the cartridge to allow the cartridge to empty. Carefully replace the cap.
- Now fit the MAXI filter cartridge. **N.B. If you're not fitting a new MAXI filter cartridge & to make it easier to re-fit the used MAXI cartridge, it's a good idea to release any water pressure in the cartridge by using the UV lamp key or similar to press one of the two valves in the bottom of the cartridge. Do this over a sink & direct the cartridge away from you.**
- Replace the lid on the top of the BIBO
- Flick the hot tank switch located at the back of the BIBO next to the power switch to ON ('1').
- **Remember to retain the cleaning system cartridge for the next time you clean your hot tank.**

Technical information

SPECIFICATION	PARAMETER
Electrical specification	
Voltage	230 Volts
Frequency	50 Hertz
Power rating	1,700 Watts
Current rating	10 Amps
Heating system	
Power rating	1,500 Watts
Heating capacity	15 Litres/hour*
Hot water temperature	70-96°C (Adjustable)
Chilling system	
Power rating	138 Watts
Cooling capacity	5 Litres/hour*
Cold water temperature	4-16°C (Adjustable)
Filtration system	
Activated carbon filter	0.5 Micron
UV filter	11 Watts
Inlet water pressure	
Minimum-Maximum	1 bar (14.5psi - 6 bar) (87psi)
Dimensions (mm)	300W x 370D x 342H
Weight	17 Kgs
Operating standards	GB4706.1-2005 GB4706.13-2008 GB4706.19-2008 GB/T22090-2008

The maximum ambient working temperature is +38°C

*The dispense capacity is calculated at an ambient and inlet water temperature of +25°C

Safety notes

- This BIBO is for indoor use only. Avoid placing it in direct sunlight or next to flammable materials. Avoid placing the BIBO near other appliances that could get damaged if wet. Do not immerse the BIBO in water.
- The BIBO uses 230VAC voltage and should be used with a 13A fuse in the plug top.
- Important: when using a new or freshly cleaned BIBO for the first time, it's important that water is flowing when both the hot and cold water keys are touched, before you switch on the hot water tank.
- BIBO can produce high temperature hot water. As with any kettle, pan or appliance capable of producing hot water please use caution when dispensing hot water.
- When your BIBO is turned on for the first time, or after a period of not being used, please run at least 2 litres of water through both the hot and cold outlets before drinking any, to ensure the water is fresh.
- Warning: The BIBO must be used with a reliable earth in the mains power supply socket.

For further notes or detailed explanations on the operation of the machine, please contact BIBO via email at customers@bibowater.co.uk

Troubleshooting

If a fault should occur, please first use the troubleshooting guide below to determine the fault type, then follow the steps listed to resolve the issue. This should help you resolve the fault with the minimum effort.

If you find that your BIBO is not working properly, or if the problem persists, your BIBO may need to be professionally repaired. Please contact us at customers@bibowater.co.uk or call 0800 678 5969 to speak to one of our team.

FAULT	POSSIBLE CAUSE	SOLUTION
No water flow	1. Machine power is not connected 2. Power socket failure 3. Inlet valve closed 4. Water tap blockage or low water pressure	1. Unplug the machine and then plug it back in again, check switch is on 2. Check the socket and fuse 3. Check that the water inlet valve is open 4. Check your water supply pressure
No hot water	1. Hot tank is not turned on 2. Hot tank thermal overload has tripped 3. Excessive water use 4. The machine was in power saving mode	1. Turn on the hot tank switch at the back 2. See the instructions how to re-set on page 22 3. Test again after 5 minutes 4. Wait for the hot tank to reach maximum temperature
No cold water	1. Chilled water temperature set too high 2. Excessive cold water use	1. Check the water temperature settings 2. Test again after 15 minutes 3. Turn off the power and wait 2 hours before turning it back on
Machine leakage	1. Drip tray is full 2. Build up of mineral deposits in the hot tank 3. Leakage inside the machine	1. Empty water drip tray and dry thoroughly before replacing 2. Clean the hot tank using the BIBO DIY cleaning kit or replace the tank 3. Turn off the power and water, please contact BIBO
Odour from water	1. New machine 2. The machine has not been used for a long time 3. The filter has not been replaced when necessary	1. Drain 2L of water from each outlet 2. Replace the MAXI filter cartridge 3. Replace the MAXI filter cartridge

Your warranty

If problems occur with the BIBO, please contact BIBO directly via email on customers@bibowater.co.uk or call us on 0800 678 5969. Do not attempt to disassemble the BIBO by yourself, doing so will invalidate the product warranty and BIBO takes no responsibility for any resulting issues.

If the BIBO develops any technical problems within the one year warranty period, we will repair your BIBO free of charge.

You can extend the warranty beyond the first year by visiting our website at www.bibowater.co.uk Appropriate maintenance costs will be charged for any damage that is caused by the misuse of the machine or that is incurred once the warranty period has ended.

Faults caused by the build-up of mineral deposits in the BIBO hot tank are not covered by the product warranty.

The Maxi filter must be replaced every 6 months and the UV Lamp every 12 months from the date of installation with BIBO approved products otherwise the warranty is invalidated.

Appendices

Self installation instructions

Please note these instructions should be used in conjunction with this user’s manual and the BIBO self-installation kit which should have been delivered with your BIBO.

These instructions should be followed by a plumber, kitchen fitter, builder, water cooler installer or similarly-experienced person. If at all unsure please call us on 0800 678 5969 and ask to speak to one of our installation team.

Water Supply Connection

In case you need to turn off the mains water supply to you home, identify were the tap/isolation valve is located.

If you have a water softener fitted in your home you can safely connect a BIBO to the softened water supply but please bear in mind that anyone on a low-sodium diet may be advised to avoid artificially softened water because the softening process replaces calcium ions with sodium ions. Water softeners are generally installed to provide water for washing, not drinking, and most people prefer to drink hard water because it tastes better. It’s normal therefore to install one un-softened “drinking water” tap to the kitchen sink, which is fed direct from the mains.

Preparation

1. As well as your BIBO the box contains a self-installation kit consisting of a length of water pipe, a BIBO ‘T’ connector, a shut-off valve and a right angle fitting. (There is included an additional length of pipe with a straight connector if needed).
2. When you’ve decided where to locate your BIBO identify a suitable mains cold water supply nearby. More often than not this will be under your kitchen sink or behind your dishwasher or washing machine. Ideally this should be a 15mm, copper pipe in good condition with enough of the pipe exposed to enable you insert the BIBO ‘T’ connector.
3. Often there is a valve to enable you to isolate the chosen pipe. If not then it will be necessary to turn off the main water supply to your home. Be sure to drain as much water as possible from the pipe before cutting it.
4. Using a suitable pipe cutter make two cuts in the pipe removing a 20mm section.
5. Push the two exposed ends of the copper pipe firmly into each end of the BIBO ‘T’ connector.
6. Make sure the tap on the BIBO ‘T’ connector is turned off i.e. parallel to the copper pipe.
7. Turn the water supply back on and make sure there are no leaks where the copper pipe fits into the BIBO ‘T’ connector.
8. Push the 6mm (white) water supply pipe provided with your BIBO firmly into the fitting on the ‘T’ piece.
9. Run this pipe behind or underneath your kitchen base cabinets then bring it up through the worktop behind your BIBO.
10. Push the end of the pipe into the (blue & white) shut-off valve (supplied with the BIBO ‘T’ connector).

Installation

Safety tips:

- Remember your BIBO weighs 17kgs so take care when lifting it from its box.
- Install your BIBO in a cool, dry place where it is well ventilated. It must be kept away from any heat source.
- Keep the rear of your BIBO at least 5cm (2”) away from the wall.
- The water pressure should be between 1 bar (14.5psi) and 6bar (87psi)
- Your BIBO needs a normal 13amp power supply.

1. Carefully remove the packaging and place your BIBO in its preferred location on the work surface.
2. Remove the plastic bag and protective covering from the cable and plug.
3. Remove the drip tray wrapping and the UV lamp ‘key’ (keep this in a safe place) from inside the drip tray.
4. Remove the protective cover from the touch screen.
5. Remove the blue locking clip from the inlet water fitting on the back of your BIBO, depress the ‘collar’ on the fitting then remove the blanking plug
6. Push the right angle water fitting (supplied with the BIBO self installation kit) into the water inlet then replace the blue locking clip.
7. Push the short length of pipe from the shut-off valve into the right angle fitting.

Setting Up

Safety tip: Make sure both power switches on the back of your BIBO are in the off (‘o’) position before connecting to the power supply (see the illustration on page 4 of this manual for guidance).

Now follow the instructions called “Using Your BIBO” on pages 6-12 of this manual and follow the BIBO’s on-screen prompts.

If you have any questions please call us: 0800 678 5969.

Re-setting the hot tank thermal overload switch

Instructions to reset the BIBO hot tank thermal overload switch

In the unlikely event that you turn your BIBO's hot tank on without filling it with water first, the BIBO will trip its thermal overload switch for safety. In order to reset this switch, first turn off the BIBO at the mains and remove the plug from the wall. Let the BIBO cool down for 30 minutes.

N.B. The following instructions assume the BIBO is facing you.

1. Remove the left hand side panel. This is held in by 2x screws at the rear of the panel, 1x at the top & 1x at the bottom. Remove the drip tray then locate 1x (smaller) screw to the left of the drip tray space.
2. Remove the lid of the BIBO then loosen the 3x screws in the top panel that run in a line on the left from front to back.
3. You will now be able to remove the side panel, start by pulling it firmly from the rear bottom corner & easing it slowly out.
4. The hot tank is encased in black insulation & is located at the front of the BIBO. The thermal overload switch is in between the two electrical connectors at the front & at the bottom of the tank. There's a small, black button at the centre that you should press to re-set. A flat blade screwdriver will do this but don't press too hard!

5. Re-fit the side panel by easing it under the top panel then snapping the bottom into the base of the BIBO. Secure it with the 3x screws, 2x at the back & 1x at the front. Do not over tighten. Finally, re-tighten the 3x screws securing the top panel & replace the lid.
6. Now plug the BIBO back in & follow the install & first use instructions on pages 6-12 of this manual.

Changing the coloured side panels

Changing the panels

BIBO's coloured side panels can be changed in the event of a kitchen redecoration or a move. New panels are available to purchase from our website www.bibowater.co.uk

In order to change the panels, first turn off the BIBO at the mains and remove the plug from the wall. Let the BIBO cool down for 30 minutes.

N.B. The following instructions assume the BIBO is facing you.

1. Remove the left hand side panel. This is held in by 2x screws at the rear of the panel, 1x at the top & 1x at the bottom. Remove the drip tray then locate 1x (smaller) screw to the left of the drip tray space.
2. Remove the lid of the BIBO then loosen the 3x screws in the top panel that run in a line on the left from front to back.
3. You will now be able to remove the side panel, start by pulling it firmly from the rear bottom corner & easing it slowly out.
4. Repeat the process with the 3x screws in the top panel that run in a line on the right from front to back and remove the right hand panel.
5. Re-fit the new side panels by easing them under the top panel then snapping the bottom into the base of the BIBO. Secure them with the 6x screws down either side and the 2x at the back & 1x at the front. Do not over tighten. Finally, re-tighten the 3x screws securing the top panel & replace the lid.

Preparing your BIBO for when you are going on holiday



How to prepare your BIBO for when you are going on holiday.



If at all unsure how to proceed please call us on 0800 678 5969 and ask to speak to one of our installation team.

Before you go:

1. Flick the hot tank switch located at the back of the BIBO next to the power switch to off ('o') (Do not switch off the power switch as this may affect the BIBO settings).
2. Turn off the water supply to the BIBO by twisting the blue tap at the back of the BIBO so that the lever is at right angles to the white water pipe.

When you come back:

1. Turn on the water supply to your BIBO by twisting the blue tap so the lever is in line with the water pipe.
2. Flick the hot tank switch at the back your BIBO to on ('I').
3. Touch the hot water key  make sure the water flows, and then touch the hot water key  again to stop.
4. The hot water tank will now begin heating.

5. It's a good idea to rinse fresh water through both tanks so remove the drip tray & place a jug or similar of at least 2ltrs capacity under the taps then follow steps 7 and 8 below:
6. Touch the cold key  and allow the water to run until it stops automatically after dispensing approximately 1.5ltrs.
7. Repeat this process by touching the hot key.  NB the water will be hot!
8. The hot tank will now take approximately 5 minutes to reach maximum temperature,.
9. Check that the day/date/time and other settings are correct. If not then follow the instructions on pages 8, 9 and 10 of your BIBO User's Manual.

Disconnecting your BIBO when moving home

1. Turn off the water supply to your BIBO where it is connected to your mains water pipe. Normally this connection consists of a white plastic 'T' connector with an integral shut-off valve. Turn the water off by twisting the **grey** lever through 90 degrees. If the connection is by way of a traditional 'washing machine' type valve twist the **blue** lever through 90 degrees.
2. Back at your BIBO touch the  to relieve any pressure in the pipe. A small volume of water may be dispensed. Touch the key again.
3. Flick the power and hot tank switches at the back of your BIBO to off ('O').
4. At the water connection on the back of your BIBO, twist the blue tap lever so it's at right angles to the water pipe. Where the pipe enters the tap, depress the collar and remove the pipe.
5. This length of water pipe should NOT be used again but can be removed from behind/under your kitchen units and disconnected from the 'T' connector or 'washing machine' valve.
6. If required, a black blanking plug is available to fill the small hole in your worktop.
7. To re-install your BIBO in your new home please follow the relevant sections of the self-installation instructions in Appendix 1 of the BIBO user's manual.

Safety tips:

- As your BIBO is full of water it now weighs 20kgs so take care when lifting it.
- It's important that your BIBO is kept upright during transportation

DON'T FORGET YOUR FILTERS!

As you exceed the recommended 6 month's life of the MAXI filter cartridge, the water your BIBO dispenses will reduce in quality and the water flow will decline as the filter becomes blocked with the contaminants it has removed.



Take advantage of our Filter Pack Delivery Service and **SAVE £24.50 every year!**

The BIBO filter pack contains two MAXI filter cartridges and a UV Lamp, **enough to last 12 months** and everything you need to keep your BIBO working correctly* and tasting great. You simply make one payment each year of £83.50 equal to just **22p per day!**

Visit www.bibowater.co.uk/product-category/filter-packs/

Or call us free of charge on 0800 6785969 and we can take your details over the phone

**Please remember that you must replace your MAXI filter cartridge and UV Lamp at the correct intervals to maintain the warranty*



DO YOUR NEIGHBOUR A FAVOUR... TELL THEM ABOUT YOUR BIBO

Hello,

If you think your neighbour, friend or family member would love the convenience of having a BIBO at home or at work do tell them about BIBO. If they do buy one for themselves then you will get your next filter pack free!

Simply fill in and tear off the form, pass it on, then if your nominated person buys a BIBO and keeps it beyond the 30 day money back period we will be in touch to arrange delivery of your gift. It's as easy as that!

BIBO



0800 678 5969

customers@bibowater.co.uk www.bibowater.co.uk



Dear _____

I thought you might like one of these? I love mine!

From _____

Tel _____ Postcode _____

Why have a BIBO?

- Boiling and chilled water at the touch of a button
- Pure, great tasting filtered water
- No more waiting for the kettle to boil
- Endless supply, no refilling!
- Say goodbye to your filter jugs and bottled water
- Choice of 12 colours to suit your kitchen
- Excellent value

Send this form back to us and we will get in touch with you to take your order.

YOUR DETAILS

Your name:-

Your e-mail address:-

Your telephone number:-

Alternatively, you can email us at **customers@bibowater.co.uk** or call us on **01993 880287**

For more information about BIBO please visit **www.biboseo.wpengine.com/what-is-bibo/**

Thank you, The BIBO Team

Moisten Here

Moisten Here

Moisten Here



Business Reply Plus

Licence Number

RTEH-ZUTG-UCTG



BIBO

2



BIBO Ltd
Blenheim Palace Sawmill
Combe
WITNEY
OX29 8ET